

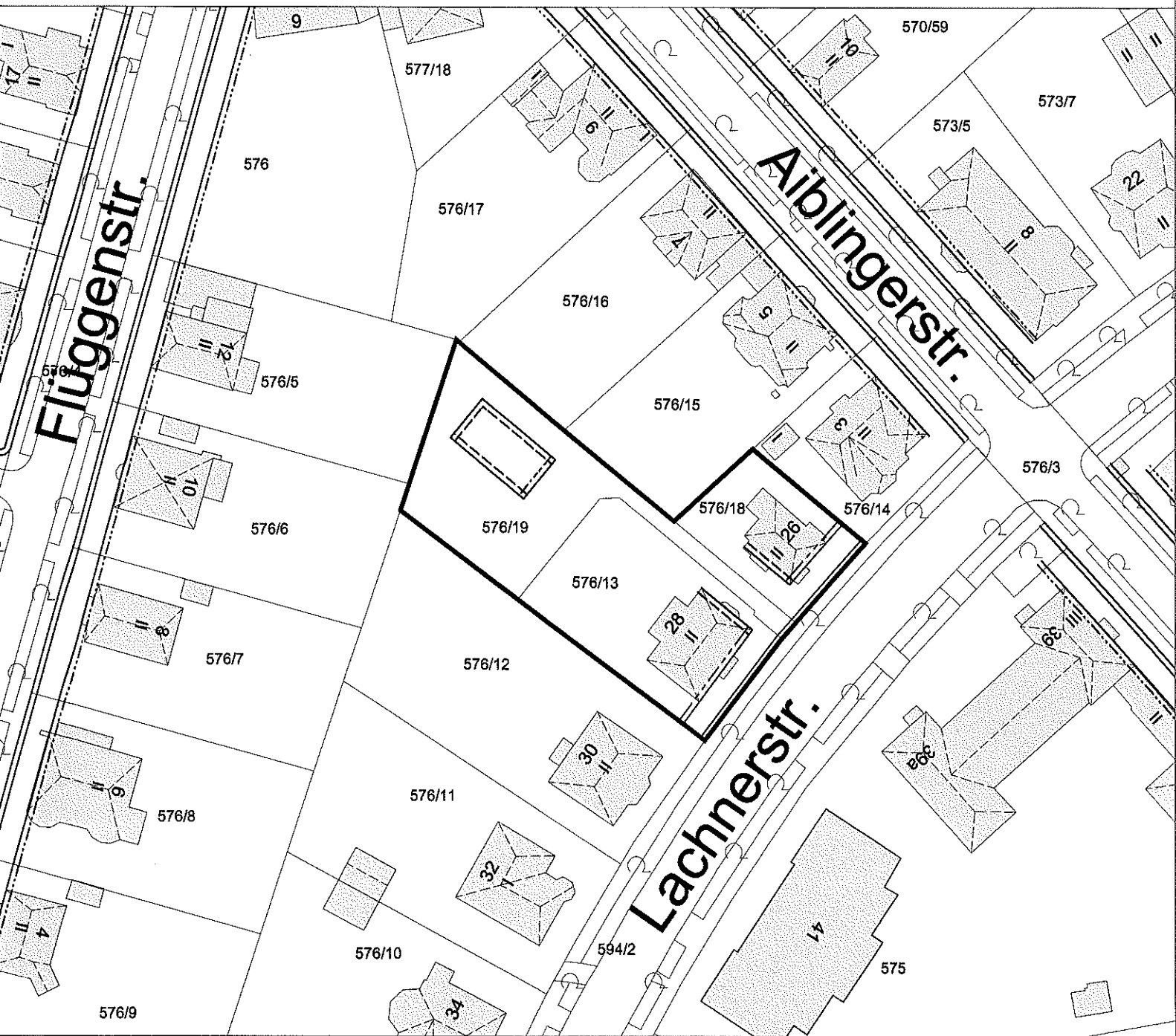

vormalige planungsrechtliche Festsetzungen
zur überbauten Grundstücksfläche
des Beb.PI.Nr.104

ANLAGE 3

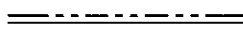
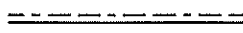
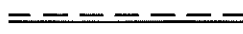
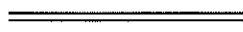

Legende:

-  Baulinie
-  Baugrenze
-  seitliche und rückwärtige Baugrenze
-  Straßenbegrenzungslinie
-  Umriff Beb.PI.Nr.104

Grundstücke:

Lachnerstraße

Flurst. Nr. 576/13, 576/18, 576/19

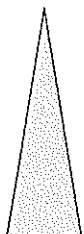

M.: o.M

LANDESHAUPTSTADT MÜNCHEN
REFERAT FÜR STADTPLANUNG
UND BAUORDNUNG HAI / 23P

AM 30.05.2017