

Bauphase I

Tierhaltung:

1275 m² BGF
1812 €/ m² BGF

Nettosumme
2.310.300,00 € (KGr.300+400)

Bruttosumme Bauphase 1:
4.933.500,00 € (KGr.100-700)

Bauphase II

Tiermed. Bereich:

795 m² BGF
1664 €/ m² BGF
Nettosumme:

1.322.880,00 € (KGr. 300+400)

Brutto Summe Bauphase 2:
2.424.390,00 € (KGr.100-700)

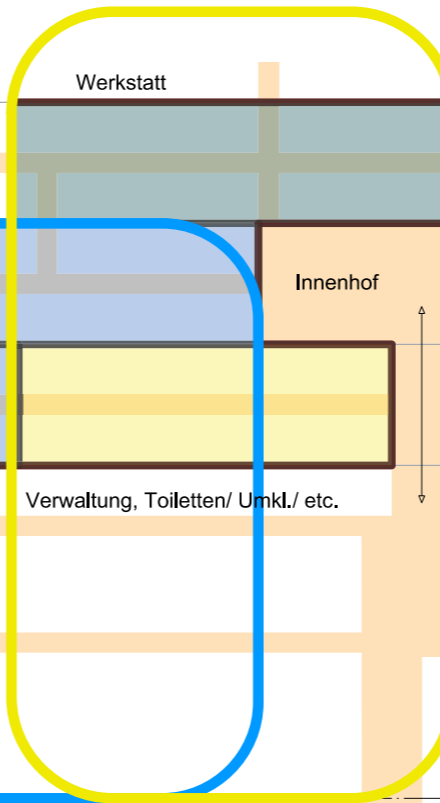

Bauphase III





Werkstatt:

525 m² BGF
1210€/ m² BGF
Nettosumme:
635.250,00 € (KGr.300+400)

Verwaltung:

445 m² BGF
1610 €/ m² BGF
Nettosumme:
716.450,00 € (KGr.300+400)

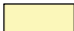
Bruttosumme Bauphase 3:
2.499.110,00 € (KGr.100-700)

	Bauphase I:	
	Tierhaltung Gebäude:	1275 m ² BGF
	Außengehege:	905 m ²
	Bauphase II:	
	Tiermedizin/ Quarantäne:	795 m ² BGF
	Bauphase III:	
	Verwaltung:	445 m ² BGF
	Werkstatt:	525 m ² BGF

Planungsstand: Juli 2018
BGF: 3040 m²

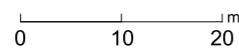

Hauptstraße

